

## QUICK LABEL 38 X 100 AUTO-ADHESIVE

Code: 320602/0

[Link to the product →](#)

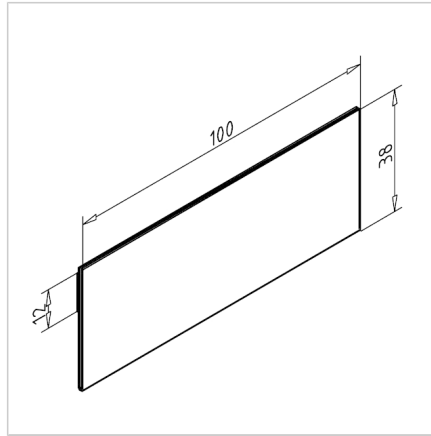
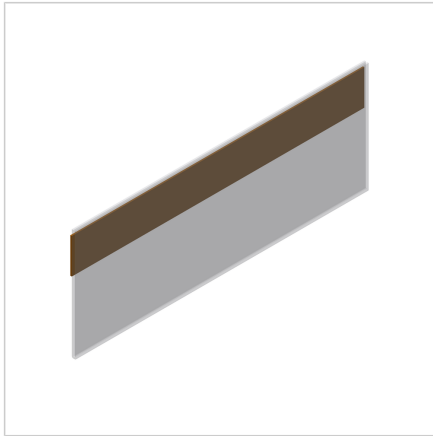

### Technical data/items supplied

- Front, transparent
- Back, self-adhesive
- Open at the sides and on top
- Weight = 0.007 kg/piece

### Applications

- Storage compartment identification
- Error-free scanning of barcodes
- For profile width 45
- If variable positioning is required, the Quick label can also be stuck on our signal profile, so that the sign can be fixed in any place in an open profile groove

### Assembly

- Attach with self-adhesive back
- Push in carton insert
- Cardboard insert not included, Pack of 14 sheets **Part no. 32.0602/1** please order separately